

IPMU研究棟のイメージ図 Image of the IPMU Building

これは2009年秋に完成予定のIPMU研究棟の模型写真です。IPMUでは、研究者の交流を重視します。自然光を取り入れた居心地の良い明るい設計で、3階には広い交流スペースがあり、5階まで吹き抜けになっています。ここには自然に人が集まり、議論が展開されることでしょう（現在検討中の案をもとに作図したもので最終像ではありません）。

This is a model of the IPMU research building that is scheduled for completion in the autumn of 2009. IMPU will place an emphasis on interaction between researchers. With a comfortable and bright design, which lets in plenty of natural light, there is a large space for meeting on the third floor, and a vaulted ceiling up to the fifth floor. People will be attracted to this place, and it will no doubt become the scene of many a long discussion. (The model was made according to the design plans currently under examination, and is not an image of the completed building)

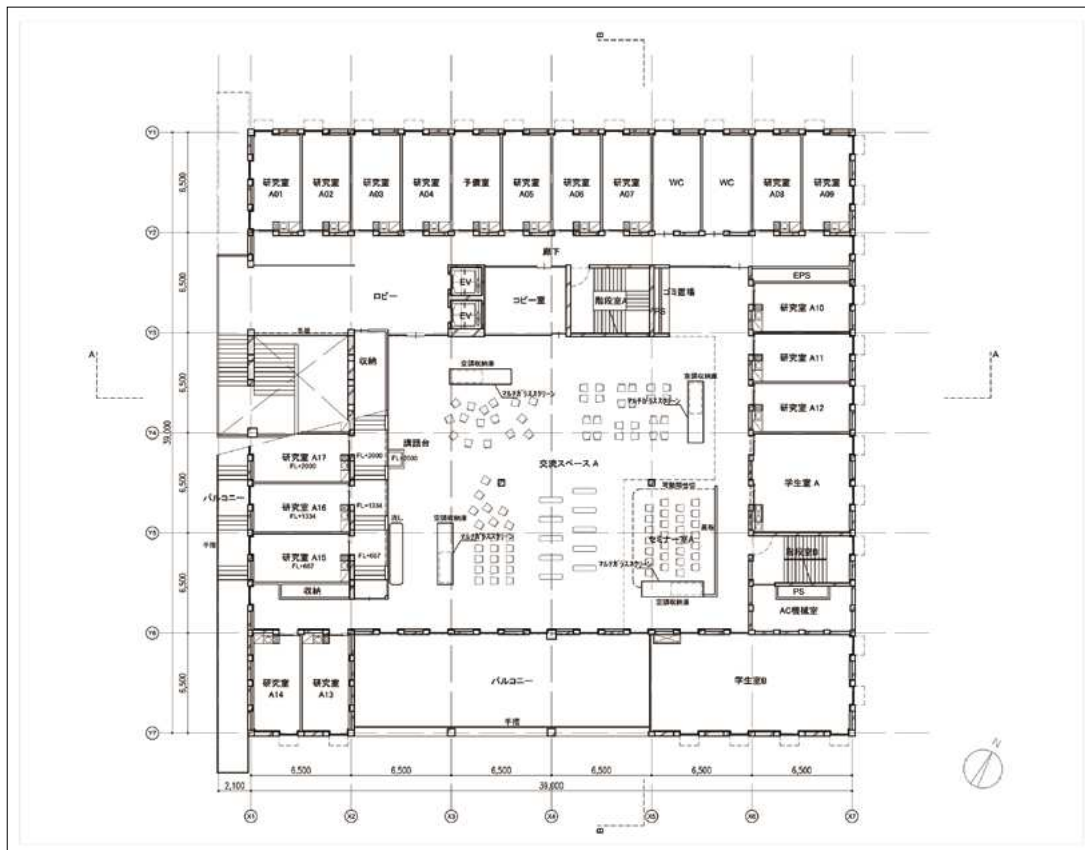

3階には広い交流スペースを設けます。
A large space for meeting will be provided on the third floor.

設計：大野秀敏+クハラ・アーキテクツ
一級建築士事務所
Designed by:
Hidetoshi Ohno
& KUHARA
Architects